

FAMILY EXPEDITIONS

HEED THE CALL OF THE WILD—TOGETHER

GALÁPAGOS ISLANDS
BAJA CALIFORNIA
& THE SEA OF CORTEZ
DEEP INSIDE ALASKA

MULTI-
GENERATIONAL
EXPERIENCES TO
SHARE IN WILDNESS

WITH
SPECIAL
SAVINGS

\$500 PER CHILD
UNDER 18 &
5% OFF FOR GROUPS
OF 8 OR MORE



ABOARD LINDBLAD-NATIONAL GEOGRAPHIC SHIPS | 2016-2017



Lindblad
Expeditions



NATIONAL
GEOGRAPHIC™



Cover: Young girl enjoys time in the surf with a Galapagos sea lion. © Sven Olof-Lindblad.

This page: Sven & his son Eric enjoy a quiet moment to review photos in Galapagos. © Stewart Cohen.

Ships' registries: United States, Ecuador.



Cover: ©. This page: ©.

DEAR TRAVELLER,

There are so many possibilities to consider when planning your family travel—and there is so much family to consider, too. When my two youngest kids, a girl and a boy three years apart, were school age, it was like having two different species in the house, with precious little connecting their interests. Add parents and extended family to the equation, and you're up to three or more different species!

Wildness is a great equaliser, allowing old and young to share experiences with equal joy. In this era of devices and seemingly limitless connectivity, it's become far too easy for family members to spend more time with their phones and tablets than each other. Expedition travel, with its mix of fresh daily sights, wildlife, undersea wonders, and activities for every age and fitness level, is the perfect antidote—to disconnect your family from the screens, the headphones and the tech-noise, and re-connect you with each other.

In addition to a superb experience, we also offer families a priceless commodity: ease. As a parent I know that there's much to be said for seamless and hassle-free. Our team provides that: every detail—from flights to food to gear—is taken care of, so all you have to do is relax and enjoy the adventure.

On behalf of our expedition teams worldwide, I hope you will choose to join us.

Best regards,

Sven-Olof Lindblad

P.S.

Please know that although we're featuring the expeditions— Galapagos, Alaska and Baja— best adapted for family travel, families are welcome on all of our expeditions, and will find the experience richly rewarding whether you head to polar, temperate, or solar regions. And the same group and kids' savings apply.

EXPERIENCE THE LINDBLAD-NATIONAL GEOGRAPHIC DIFFERENCE CELEBRATING 50 YEARS OF EXPEDITION TRAVEL

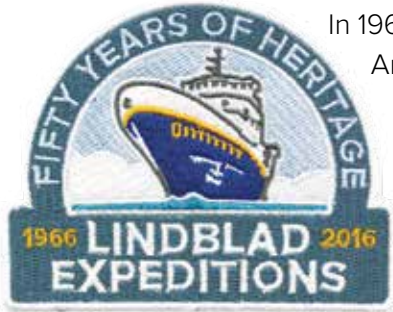

In 1966 Lars-Eric Lindblad took the first-ever citizen explorers to Antarctica, effectively inventing expedition travel, and we have been exploring the planet ever since. We have introduced hundreds of families to the wonders of wild, remote places; and we have learned what it means for families to experience these unique places together. Carefully crafted to make the most of your time and interest, our expeditions also allow flexibility and spontaneity—Breaching whales to starboard! Dolphins at the bow! Migrating sea turtles, let's snorkel!—to be part of the experience. Rely on us to provide authentic, hands-on fun that rewards you with magic, meaning and shared memories for life.



Snorkelling with sea lions in Baja is a thrill.



Zodiac cruising provides up-close interactions with marine wildlife.



Pristine Galápagos beaches inspire joy.

Travel + Leisure named us the **#1 Family Friendly Small-ship Cruise Line** for **four consecutive years**. The fact that we go to remarkable geographies and see and do engaging things are major reasons to choose us. But what will surprise and delight you, is how much being aboard an expedition ship—with the safe autonomy and sense of adventure this offers kids—will add to your whole family's experience. You'll see kids gain confidence, and discover hidden talents, while having the time of their lives.

Watch how families explore with us!

CHECK OUT OUR FAMILY VIDEOS AT
[EXPEDITIONS.COM/FAMILYVIDEOS](https://www.expeditions.com/familyvideos)

OUR A+ EXPEDITION TEAM ENHANCES YOUR FAMILY'S EXPERIENCE

Whether your family consists of a twosome, a nuclear unit, or a sprawling multi-generation clan, our expedition team, renowned for their engaging expertise, is equipped to lead you through activities and experiences that will expand your minds and hearts—together.



Each naturalist is an expert in his/her field—marine biology, evolutionary biology, ornithology and more—and specifically trained to work with kids, tailoring activities by age group and interest. Our excellent staff-to-guest ratio ensures a healthy diversity. You and yours are never assigned, and are free to gravitate toward the naturalist whose interests mirror your own. And our expedition leaders orchestrate each day to ensure maximum engagement.

REPRESENTING OUR EXPERT EXPEDITION STAFF



JONATHAN AGUAS



JEN MARTIN



MIKE GREENFELDER



LINDA BURBACK



JASON HEILMANN



PAULA TAGLE



Kids bonding on a Zodiac ride in Galápagos.

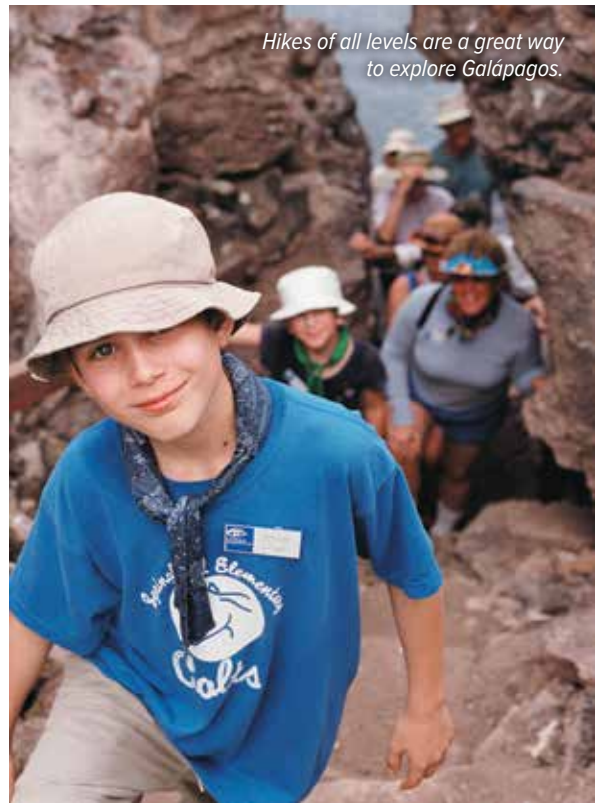

Hikes of all levels are a great way to explore Galápagos.



Families of all ages reconnect and celebrate milestones together.





Expedition landing craft provides a front row seat to the excitement.



Kids enjoy learning about photography with an endless variety of wildlife to shoot.

TAKE YOUR BEST PHOTOS EVER



Brown bear, Southeast Alaska.

The wild world presents non-stop photo ops. And when you explore them with us, you can take ultimate advantage—thanks to our exclusive Expedition Photography program. You'll have a Lindblad Expeditions-National Geographic certified photo instructor onboard and at your service. Skilled photo instructors, trained by top National Geographic photographers, and veteran naturalists, will provide tips or instruction, and will help you better understand wildlife behaviour so you can better anticipate and capture great moments. And kids take to our photography program like proverbial ducks to water—learning, experimenting, and documenting their experience in imaginative and insightful ways. Photography is highly shareable—photographers display shots in recap presentations—and everyone gets caught up in the fun. So, whether you use a smartphone, point-and-shoot, or a DSLR, or haven't tried photography, count on going home with great shots.

A SMART KIDS PROGRAM + FAMILY ACTIVITIES TO SHARE

Your family will see, learn and do more by exploring the Galápagos, Baja, or Alaska with experts who know those regions best. Kids on our expeditions can count on these engaging activities:

✓ Connect with nature

See what happens when kids disconnect from tech and have direct contact with wildlife & wonders. With no screens to intervene, you'll re-discover each other on the voyage, too



✓ Get certified to drive

Kids learn to drive an expedition landing craft and earn a 'certificate of achievement'. And, get kid-friendly menu options, stargazing, a scavenger hunt, nautical knot-tying, and a special pizza & movie night, too

✓ Learn journal keeping

Keep an expedition journal, to observe and preserve all the new, enriching experiences; or paint watercolours using glacial ice to link art & science





✓ Observe nature through the lens

Take a photo workshop with a Lindblad-National Geographic certified photo instructor, using smart phones, DSLRs, or point & shoot cameras

✓ Learn ship navigation

Visit the Bridge together to watch the Captain and crew navigate, and learn about the navigational instruments



✓ Learn hands-on science

Whether learning about glaciers by making ice cream sundaes, or using the video microscope to see life in miniature, kids get lasting value from hands-on nature lessons

✓ Experience giving back

Kids can contribute in Galápagos by donating their favourite book to the Tomás de Berlanga School; or learn to identify humpback and killer whale flukes in Alaska and submit findings to researchers



GALÁPAGOS

10 DAYS/9 NIGHTS—ABOARD NATIONAL GEOGRAPHIC ENDEAVOUR/ENDEAVOUR II* AND NATIONAL GEOGRAPHIC ISLANDER

PRICES FROM: \$8,240 to \$17,700 (See pages 18-23 for complete prices.)

Special offers may apply to select dates; please visit expeditions.com/special-offers or call for details.

It's different in Galápagos, “a little world within itself,” as Darwin described it, where magical encounters with animals—curious, or sublimely indifferent to our presence—happen like nowhere else on earth. Each island is different. The undersea offers you a remarkable experience. And when you explore with us you experience it all, in a different, more in-depth way than any other company can offer.

EXPEDITION HIGHLIGHTS

- ▶ Snorkel amid shimmering fish, sea turtles, penguins, and playful sea lions.
- ▶ Cruise to pristine islands, and walk among colonies of wildlife and birds unfazed by your presence.
- ▶ Observe rare giant tortoises in the wild.
- ▶ Explore the waters of the Galápagos by glass-bottom boat (*Endeavour* only), kayak, or Zodiac.

See giant Galápagos tortoises up close.

EXPERIENCE & EXPERTISE

50
YEARS
EXPERIENCE

In the nearly 50 years we've been exploring Galápagos, we've introduced generations of travellers to its magic and mystery. We're committed to Galápagos; and have raised millions, along with our guests, for its conservation. Since our 1967 beginning in Galápagos we've operated ships based there year-round, staffed with an expedition leader, a team of naturalists, a Lindblad-National Geographic certified photo instructor, undersea specialist, wellness specialist and video chronicler to contribute to your experience. And to maximize opportunities for families, we add an extra naturalist to our Galápagos summer expeditions—ensuring focus on enhancing each kid's experience.

Visit expeditions.com/galapagos to read staff bios for this expedition.



EXPLORING ALASKA'S COASTAL WILDERNESS

8 DAYS/7 NIGHTS—ABOARD NATIONAL GEOGRAPHIC SEA LION AND NATIONAL GEOGRAPHIC QUEST

PRICES FROM: \$7,370 to \$13,250 (See pages 24-27 for complete prices.)

Special offers may apply to select dates; please visit expeditions.com/special-offers or call for details.

Experience the remarkable beauty of Southeast Alaska on a voyage aboard the *National Geographic Sea Lion* into a land of mist-shrouded fjords, tidewater glaciers, and islands teeming with wildlife. Search for orcas and humpback whales, kayak amid glacial ice, spend a full day in Glacier Bay National Park, and learn about Alaska's rich Tlingit heritage.

EXPEDITION HIGHLIGHTS

- ▶ Kayak into protected coves and look for sea otters, seabirds, and harbour seals.
- ▶ Hike through lush forests to cascading waterfalls, and ride an expedition landing craft into coves to look for brown bears.
- ▶ Meet members of the Alaska Whale Foundation to learn about the local whale population, and get a firsthand perspective on Alaska's indigenous people from a Tlingit cultural interpreter.
- ▶ Discover Alaska's seldom-seen, vibrant marine life revealed by our undersea specialist.

EXPERIENCE & EXPERTISE



Our unparalleled 6-person expedition team aboard the *National Geographic Sea Lion* or 10-person team aboard the *National Geographic Quest* is key to an in-depth experience. An expedition leader, 3 or 7 naturalists (depending on the ship), a Lindblad-National Geographic certified photo instructor and undersea specialist, plus a wellness specialist and video chronicler all contribute to your understanding of Alaska's wonders. Certain departures will feature a National Geographic photographer or expert.

Visit our [website](#) to read staff and guest speaker bios for this expedition.

A humpback whale breaches near the ship.



DAY 1: SEATTLE/JUNEAU/EMBARK

Fly from Seattle to Juneau. Meet your naturalists and visit Mendenhall Glacier, set in the dramatic Mendenhall Valley. Settle into your cabin before dinner. Later, explore the port of Juneau on your own. (D)

DAY 2: TRACY ARM—FORDS TERROR WILDERNESS

Voyage into Tracy or Endicott Arm, both spectacular fjords, with waterfalls cascading from glacially carved walls. See the soaring Dawes or South Sawyer Glacier up close and take a cruise in an expedition landing craft for an unbeatable view of sculpted icebergs. Keep an eye out for harbour seals, porpoises and arctic terns. (B,L,D)



Petersburg.

DAY 3: PETERSBURG

Search for humpback whales as we head towards the small, true Alaskan town of Petersburg on Mitkof Island. Explore a unique Southeast Alaskan ecosystem, the 'muskeg', with stunted trees and carnivorous plants. There is an opportunity for bike riding and an optional floatplane excursion. Enjoy a crab feast this evening. (B,L,D)

DAY 4: FREDERICK SOUND AND CHATHAM STRAIT

With luck, we'll see whales breaching, tail-slapping and feeding. We'll explore spectacular bays and inlets, following bear trails and salmon streams. Later, hike or kayak for up close exploration. (B,L,D)

DAY 5: ICY STRAIT AND THE INIAN ISLANDS

Explore among the Inian Islands, where an abundance of Steller sea lions and sea otters reside. We'll search for whales in the rich waters of Icy Strait and choose the perfect spot around Chichagof Island to hike and kayak. (B,L,D)

DAY 6: GLACIER BAY NATIONAL PARK

By special permit, we explore Glacier Bay, a not-to-be-missed gem of Alaska. See glaciers that end abruptly at the water's edge and observe them 'calving'—tons of ice crashing into the sea—accompanied by an exhilaratingly thunderous sound. Wilderness abounds—mountain goats and brown bears patrol the shore; harbour seals, Steller sea lions and puffins live in these icy waters. A native Tlingit interpreter joins us to share the lore and legend of the area. We will also be joined by a National Park Service Ranger. (B,L,D)

DAY 7: SOUTHEAST ALASKA'S ISLANDS, BAYS AND FJORDS

Today, nature is our guide. We may explore an isolated beach to take a closer look at tide pools, beachcomb, and hike stunning forest trails, or see bear tracks worn into the soil while walking an isolated meadow. Sightings of bald eagles are very common. If conditions permit, we'll do some kayaking, always watching for marine and terrestrial life. (B,L,D)

DAY 8: SITKA/DISEMBARK/SEATTLE

After breakfast we disembark in Sitka, Southeast Alaska's only oceanfront town. Visit the onion-domed St. Michael's Russian Orthodox Church. At the Raptor Rehabilitation Centre, we have close views of species normally seen at a distance. Drive to the airport for our afternoon flight to Seattle. (B)

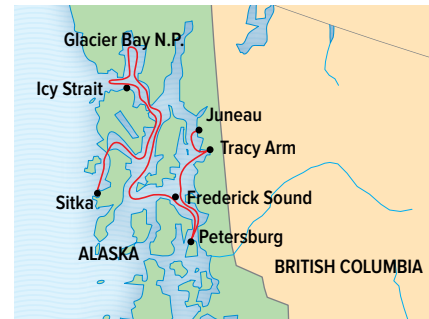

EXPEDITION DETAILS

DATES: 2017 May 14*, 21, 28*; Jun. 4, 11*, 18, 25*; Jul. 2, 9*, 16, 23*; Aug. 13, 20*, 27 (*Sea Lion*)
2017 Jul. 8* 📷, 15, 22*, 29; Aug. 5*, 12, 19*, 26 (*Quest*)

*Indicates itineraries in the reverse order, from Sitka to Juneau.

NATIONAL GEOGRAPHIC PHOTOGRAPHERS

Travel with photographer **Andy Mann** on the Sep. 3, 2016, National Geographic photographer **Rich Reid** (right) on the Sep. 4, 2016 departure or **Flip Nicklin** on the Jul. 8, 2017 departure aboard the *National Geographic Sea Bird & Sea Lion*.



EXTEND YOUR ADVENTURE

Make the most of your time in Southeast Alaska. See pages 16-17 for more information about other expeditions and extending your adventure.



We know the perfect coves for kayaking.

BAJA CALIFORNIA AND THE SEA OF CORTEZ: AMONG THE GREAT WHALES

8 DAYS/7 NIGHTS—ABOARD NATIONAL GEOGRAPHIC SEA BIRD

PRICES FROM: \$8,240 to \$14,240 (See page 24 for complete prices.)

Special offers may apply to select dates; please visit expeditions.com/special-offers or call for details.

Seeing gray whales in their natural habitat is one of the great delights of this voyage. In Bahía Magdalena, venture out in expedition landing craft among these magnificent creatures. In the Sea of Cortez, search for a variety of whales, plus dolphins, blue-footed boobies, pelicans, cormorants and magnificent frigatebirds. You'll also snorkel among sea lions, join naturalists on hikes amid barrel cacti and sculpted sand dunes, and see a variety of desert flora and fauna.

EXPEDITION HIGHLIGHTS

- ▶ Get an up-close view of gigantic gray whale mothers and their calves in the breeding grounds of Bahía Magdalena.
- ▶ Go snorkelling amid sea lions, brilliant blue damselfish, and schools of king angelfish.
- ▶ Kayak clear blue waters on the lookout for a variety of bird species including magnificent frigatebirds.
- ▶ Explore diverse landscapes, including sand dunes, a cactus forest and deserted islands.

EXPERIENCE & EXPERTISE



Our expert 6-person expedition team will illuminate the wonders of the Sea of Cortez from every possible angle.

Your expedition leader, undersea specialist, Lindblad-National Geographic certified photo instructor and naturalists, plus a wellness specialist and video chronicler, are dedicated to ensuring an incredible voyage. Certain departures feature a National Geographic photographer.

Watch kids enjoy an afternoon of paddleboarding in Baja at: www.expeditions.com/bajapaddle

California gray whale photographed half above and half below the water.



DAY 1: LA PAZ/SAN CARLOS/EMBARK

Upon arrival in La Paz, transfer to San Carlos where we embark. (D)

DAYS 2-4: BAHÍA MAGDALENA

Navigate through an immense system of protected coves and channels, surrounded by a fringe of mangrove channels at one edge of a vast, windswept plain. Each winter, during their long migration, gray whales travel south from their Arctic feeding grounds to breed and raise their calves in these sheltered waters. Observe migrating whales from the ship and up close from our expedition landing craft. Watch for magnificent frigatebirds, pelicans, cormorants, terns, great blue herons, ibis and willets. (B,L,D daily)

DAY 5: LOS CABOS AND GORDA

Our fleet of nimble expedition landing craft provide water-level exploration.



CORTEZ

Today is a day with the luxury of no specific plan. You may spend time on the lookout for whales, bottlenose and common dolphin, or explore some of the many uninhabited islands such as Isla San Francisco or Isla San Jose, known for its sweeping beaches and arroyos. Birdlife may be plentiful, and the nutrient-rich sea is home to an overwhelming variety of fish: king angelfish, surgeonfish, butterfly fish, damselfish, and the beautiful parrotfish. (B,L,D)



iPhone photographer.

DAY 8: LA PAZ/DISEMBARK

Disembark in La Paz after breakfast and drive to the airport for onwards flights. (B)



EXPEDITION DETAILS

DATES: 2017 Jan. 14*, 21, 28*; Feb. 4, 11*, 18, 25*; Mar. 4, 11*

*These departures travel in reverse from La Paz to San Carlos, making all the same stops.

NATIONAL GEOGRAPHIC EXPERT

Greg Marshall is a scientist, inventor, and filmmaker who has dedicated the last 25 years to studying, exploring, and documenting life in the oceans. He is the inventor of Crittercam, a research tool used to record data from an animal's perspective. Join Greg on the Jan. 14 voyage.



EXTEND YOUR ADVENTURE

Make the most of your time in Baja California. See pages 16-17 for more information about other expeditions and extending your adventure.

BANKS

This morning cruise past Friars Rocks at Land's End. For those who wish, we will visit the historic town centre of San José del Cabo. The afternoon is spent at the Gorda Banks seamount or La Fortuna, gathering places for whales, especially humpbacks, dolphins and other sea life. (B,L,D)

DAY 6: LOS ISLOTES AND ISLA ESPÍRITU SANTO

At Los Islotes, don flippers, a mask and snorkel (which we'll gladly provide) and swim with curious sea lions. We have a leisurely afternoon to swim, kayak or hike at Isla Espíritu Santo. Brown pelicans, gulls and boobies are all part of the landscape. Finish the day with a relaxing beach barbeque complete with a bonfire and a star-filled sky. (B,L,D)

DAY 7: EXPLORING THE SEA OF



After a beach barbeque, guests gather around a bonfire.

MAKE THE MOST OF YOUR TIME TOGETHER— EXPLORE MORE

The itineraries featured in this brochure are only part of the story. We offer alternate itineraries in Alaska and Baja California. And in Galápagos, the opportunity to seamlessly venture further into the region. Antarctica and the Arctic are fascinating family choices as well. Plus, extensions in each geography extend the opportunities to see, do and learn together.

Please visit www.expeditions.com for more information & videos.

Galápagos + Machu Picchu & Peru's Land of The Incas

16 DAYS/15 NIGHTS—ABOARD NATIONAL GEOGRAPHIC ENDEAVOUR, ENDEAVOUR II, ISLANDER PLUS PERU LAND PROGRAM

Galápagos + The Upper Amazon

20 DAYS/19 NIGHTS ABOARD NATIONAL GEOGRAPHIC ENDEAVOUR, ENDEAVOUR II, ISLANDER AND DELFIN II

Epic Galápagos Photo Expedition

17 DAYS/16 NIGHTS ABOARD NATIONAL GEOGRAPHIC ENDEAVOUR AND ENDEAVOUR II



The Inca city of Machu Picchu.



Families enjoy afternoon hikes through Southeast Alaska.

Wild Alaska Escape

6 DAYS/5 NIGHTS—ABOARD NATIONAL GEOGRAPHIC SEA BIRD

Treasures Of The Inside Passage: Alaska And British Columbia

13 DAYS/12 NIGHTS—ABOARD NATIONAL GEOGRAPHIC QUEST

Big Picture Alaska

11 DAYS/10 NIGHTS—ABOARD NATIONAL GEOGRAPHIC SEA BIRD

Note: This a photo-centric expedition, open to all levels of photographers.

Whales & Wildness: Spring In The Sea Of Cortez

8 DAYS/7 NIGHTS ABOARD NATIONAL GEOGRAPHIC SEA BIRD AND NATIONAL GEOGRAPHIC SEA LION

Wild Islands & Treasures of Baja California

8 DAYS/7 NIGHTS ABOARD NATIONAL GEOGRAPHIC SEA BIRD

Baja California: A Remarkable Journey

15 DAYS/14 NIGHTS ABOARD NATIONAL GEOGRAPHIC SEA BIRD AND NATIONAL GEOGRAPHIC SEA LION

Note: This a photo-centric expedition, open to all levels of photographers



Thrilling up-close encounters with California gray whales in Baja California.



NATIONAL GEOGRAPHIC ISLANDER IN GALÁPAGOS

CAPACITY: 48 guests in 24 outside cabins.

REGISTRY: Ecuador. **OVERALL LENGTH:** 50 metres.

PUBLIC AREAS: Ship is fully air-conditioned. Covered deck with hammocks, chairs and tables; doctor's office; fitness centre; global market; LEXspa; library; lounge with full-service bar and facilities for films, and presentations; and sky deck. Our Ecuadorian captain welcomes guests to the bridge in accordance with our 'open bridge' policy.

MEALS: Served in single seatings with unassigned tables, meals are informal. Menu is international with an Ecuadorian flair.

CABINS: All cabins have a window with an outside view, private facilities and climate controls.

EXPEDITION EQUIPMENT: Kayaks, snorkelling gear, underwater video camera, video microscope, wet suits, Zodiac landing craft.

SPECIAL FEATURES: Internet access, laundry service, ship's doctor, wellness specialist, and video chronicler.

WELLNESS: The vessel is staffed by a wellness specialist and features exercise equipment and outdoor stretching area.



Insets clockwise from top: Our hospitality staff is at your service and an integral part of your expedition; Category 4 cabin; Category 5 cabin.

CATEGORY 1: Main Deck #201-206—Cabins feature a window and two lower single beds which can convert to a queen bed.

CATEGORY 2: Main Deck #207-210; Bridge Deck #301-302—Centrally located cabins feature a window and two lower single beds which can convert to a queen bed.

CATEGORY 3: Bridge Deck #303-306—Cabins feature a window and two lower single beds which can convert to a queen bed. Cabins 305 & 306 can accommodate a third person.

CATEGORY 4: Upper Deck #403-408—Spacious cabins feature two lower single beds which can convert to a lower queen bed. All cabins feature a window and outside glassed-in terraces with seating. There are large windows in the top half of the terrace doors.

CATEGORY 5: Upper Deck #401 and 402—These are the largest cabins on board. They feature wrap around windows and two lower single beds which can convert to a queen bed. Both have a desk, chairs, and table. They also feature outside glassed in terraces with seating.

NOTE: Sole Occupancy cabins are available in Categories 1 and 2 only. Third person rates are available in certain categories at one half the double occupancy rate.

SHARED ACCOMMODATIONS: Shares can be arranged at the double occupancy rate in Categories 1 and 2 only.

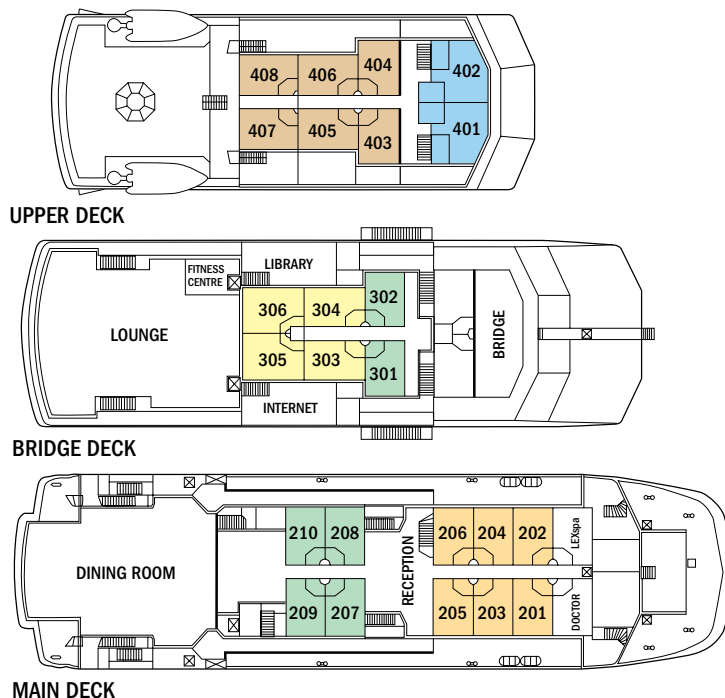

Prices are per person, double occupancy, in Australian dollars unless indicated as solo.

ITINERARY	CAT. 1	CAT. 2	CAT. 3	CAT. 4	CAT. 5	CAT. 1 SOLO	CAT. 2 SOLO	DEPOSIT	NOTE	
2016 GALÁPAGOS: ABOARD NATIONAL GEOGRAPHIC ISLANDER PAGE 10										
Jan. 2 - Dec. 10	\$8,740	\$9,860	\$10,970	\$11,610	\$14,110	\$13,100	\$14,790	\$750	International and internal Ecuador tickets must be issued separately for all Galápagos voyages. Sample Internal Airfares: Guayaquil/ Galápagos: Adult from \$650 Children (Under 12) from \$325. Call for sample Peru airfare.	
Holiday: Dec. 17, 24	\$9,990	\$11,240	\$12,220	\$12,970	\$15,560	\$14,990	\$16,860	\$1,000		
2016 GALÁPAGOS + MACHU PICCHU & THE LAND OF THE INCA PAGE 16										
Jan. 3 - Dec. 3	\$15,600	\$16,730	\$17,480	\$18,480	\$20,980	\$21,710	\$23,400	\$1,500		
Dec. 10	\$16,480	\$17,600	\$18,710	\$19,350	\$21,850	\$22,590	\$24,280	\$1,500		
Holiday: Dec. 24	\$16,850	\$18,100	\$19,090	\$19,840	\$22,430	\$23,600	\$25,480	\$1,500		
2017 GALÁPAGOS: ABOARD NATIONAL GEOGRAPHIC ISLANDER PAGE 10										
Dec. 31, 2016 - Dec. 16, 2017	\$9,160	\$10,360	\$11,460	\$12,190	\$14,830	\$13,740	\$15,550	\$750		
Holiday: Dec. 23, 30	\$10,490	\$11,800	\$12,840	\$13,620	\$16,340	\$15,740	\$17,700	\$1,000		
2017 GALÁPAGOS + MACHU PICCHU & THE LAND OF THE INCA PAGE 16										
Jan. 14 - Nov. 25	\$16,270	\$17,470	\$18,570	\$19,300	\$21,940	\$22,580	\$24,390	\$1,500		
Dec. 9	\$17,190	\$18,390	\$19,490	\$20,210	\$22,850	\$23,490	\$25,300	\$1,500		
Holiday: Dec. 23	\$18,510	\$19,820	\$20,860	\$21,640	\$24,360	\$25,490	\$27,450	\$1,500		



NATIONAL GEOGRAPHIC ENDEAVOUR IN GALÁPAGOS

CAPACITY: 96 guests in 56 outside cabins.
REGISTRY: Ecuador. **OVERALL LENGTH:** 90 metres.

PUBLIC AREAS: Ship is fully air-conditioned. Covered deck with chairs and tables; doctor's office; fitness centre; LEXspa; global gallery; library; lounge with full-service bar and facilities for films, and presentations; sauna and small swimming pool; and sun deck. Our Ecuadorian captain welcomes guests to the bridge in accordance with our 'open bridge' policy.

MEALS: Served in single seatings with unassigned tables for an informal atmosphere. Menu is international with Ecuadorian flair.

CABINS: All cabins face outside with windows or portholes. Each has private facilities and climate controls.

EXPEDITION EQUIPMENT: Kayaks, glass-bottom boat, snorkelling gear, underwater video camera, video microscope, wet suits, and Zodiac landing craft.

SPECIAL FEATURES: Guest internet access, laundry service, and wellness program. Ship's doctor and video chronicler are also on board.



Insets clockwise from top: Open dining room with unassigned seating for an informal atmosphere; well stocked library; swimming pool.



Category 3 cabin.



Category 5 cabin.



Category 4 cabin.

CATEGORY 1: Main Deck #202, 204, A Deck #352, 353—All cabins feature two lower single beds, a writing desk and a porthole.

CATEGORY 2: Upper Deck #122, 125; Main Deck #201, 203, 206, 208, 210-212, 214-218, 220—Cabins have two lower single beds and a writing desk. Upper Deck Cabins feature large windows & Main Deck cabins have two portholes.

CATEGORY 3: Main Deck #209; A Deck #300, 350, 351—These spacious cabins accommodate two or three people, all with two lower beds, a sitting chair, a writing desk and two portholes. Each has a separate sleeping and sitting area.

CATEGORY 4: Upper Deck #102, 104-112, 114-116, 118, 120, 121, 123—Conveniently located cabins feature two lower single beds, a writing desk, and a large window.

CATEGORY 5: Upper Deck #117, 129—The finest accommodations on board. Suites have separate sleeping and sitting areas, a large view window and a convertible sofa to accommodate a third person.

CATEGORY 1 SOLO: Main Deck #219, 222; A Deck #309-312, 314-316, 318

CATEGORY 2 SOLO: Upper Deck #124, 126, 127; Main Deck #205

NOTE: Sole Occupancy cabins are available in Categories 1 and 2 and have one lower single bed and one porthole.

SHARED ACCOMMODATIONS: We will make arrangements for shared accommodations at the double occupancy rate in Categories 1 and 2. Third person rates are available in designated cabins at one half the double occupancy rate.

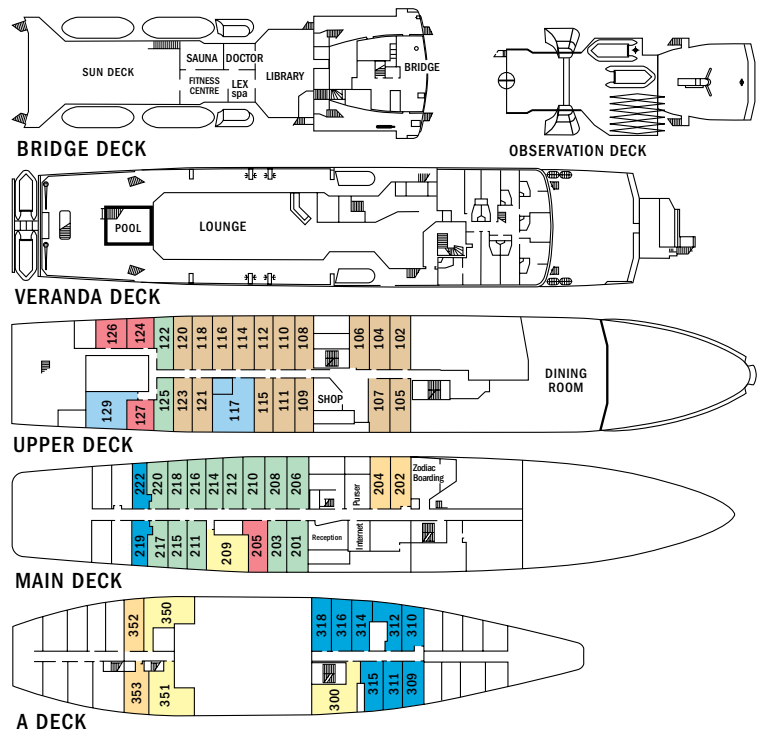

Prices are per person, double occupancy, in Australian dollars unless indicated as solo.

ITINERARY	CAT. 1	CAT. 2	CAT. 3	CAT. 4	CAT. 5	CAT. 1 SOLO	CAT. 2 SOLO	DEPOSIT	NOTE	
2016 GALÁPAGOS: ABOARD NATIONAL GEOGRAPHIC ENDEAVOUR PAGE 10										
Jan. 1 - Dec. 15	\$8,240	\$9,360	\$9,990	\$10,990	\$13,610	\$10,300	\$11,700	\$750	International and internal Ecuador tickets must be issued separately for all Galápagos voyages. Sample Internal Airfares: Guayaquil/ Galápagos: Adult from \$650 Children (Under 12) from \$325. Call for sample Peru airfare.	
Holiday: Dec. 23, 30	\$9,440	\$10,560	\$11,240	\$12,360	\$14,990	\$11,800	\$13,200	\$1,000		
2016 GALÁPAGOS + MACHU PICCHU & THE LAND OF THE INCA PAGE 16										
Jan. 1 - Dec. 15	\$15,100	\$16,230	\$16,850	\$17,850	\$20,480	\$18,910	\$20,310	\$1,500		
Dec. 16	\$15,980	\$17,100	\$17,730	\$18,730	\$21,350	\$19,790	\$21,190	\$1,500		
Holiday: Dec. 30	\$17,180	\$18,300	\$18,980	\$20,100	\$22,730	\$21,250	\$22,650	\$1,500		
2016 EPIC GALÁPAGOS PHOTO EXPEDITION ABOARD NATIONAL GEOGRAPHIC ENDEAVOUR PAGE 16										
Dec. 2	\$16,480	\$18,720	\$19,980	\$21,980	\$27,220	\$20,600	\$23,400	\$1,500		



NATIONAL GEOGRAPHIC ENDEAVOUR II IN GALÁPAGOS

CAPACITY: 96 guests in 53 outside cabins

REGISTRY: Ecuador.

OVERALL LENGTH: 73 metres.

PUBLIC AREAS: Ship is fully air-conditioned. Covered deck with chairs and tables; doctor's office; fitness centre; LEXspa; global gallery; library; lounge with full-service bar and facilities for viewing and presentations; and sun deck. Our Ecuadorian captain welcomes guests to the bridge in accordance with our 'open bridge' policy.

MEALS: Served in single seatings with unassigned tables for an informal atmosphere. Menu is international with Ecuadorian flair.

CABINS: All cabins face outside with windows. Each has private facilities and climate controls.

EXPEDITION EQUIPMENT: Zodiac landing craft, glass-bottom Zodiac, tandem kayaks, shorty wetsuits, snorkels, masks, fins, snorkel buoyancy vests, video microscope, video camera, plankton net, and walking sticks.

SPECIAL FEATURES: Guest internet access, laundry service, and wellness program. Ship's doctor and video chronicler are also on board.



Top to bottom: National Geographic Endeavour II will feature 53 cabins accommodating 96 guests and will replace National Geographic Endeavour in January 2017; the newly renovated lounge's panoramic windows ensure stunning Galápagos landscape views; artist rendering of a typical category 3 cabin.



CATEGORY 1: Upper Deck #201, 202—All cabins feature two lower single beds that can convert to a queen bed, armchair, and a large window.

CATEGORY 2: Upper Deck #214-219, 221-222, 224-231—All cabins feature two lower single beds that can convert to a queen bed, armchair, and a large window. Cabins 230 & 231 can accommodate a third person in an upper fold down murphy bed.

CATEGORY 3: Lounge Deck #311, 313-318, 322, 324, 326, 328, 330—All cabins feature two lower single beds that can convert to a queen bed, armchair, and a large window. Cabins 326 & 328 can accommodate a third person in an upper fold down murphy bed.

CATEGORY 4: Bridge Deck #409, 411-418—All cabins feature two lower single beds that can convert to a queen bed, armchair, and a large window.

SUITE A: Lounge Deck – Suite #320—Cabin features very comfortable location onboard the vessel, two lower single beds that can convert to a queen bed, writing desk, bathroom suite, armchair, and a large window.

SUITE B: Bridge Deck – Suites #420, 422—All cabins feature very comfortable location onboard the vessel, two lower single beds that can convert to a queen bed, writing desk, bathroom suite, convertible sofa to accommodate a third person and a floor to ceiling window.

CATEGORY 2 SOLO: Upper Deck #203-209, 211, 213—All cabins feature a single bed, armchair, and a large window.

CATEGORY 3 SOLO: Lounge Deck #325, 327—All cabins feature a single bed, armchair, and a large window.

NOTE: Sole Occupancy cabins are available in Categories 2 and 3 and have one lower single queen size bed and one large window.

SHARED ACCOMMODATIONS: We will make arrangements for shared accommodations at the double occupancy rate in Categories 1 and 2. Third person rates are available in designated cabins at one half the double occupancy rate.

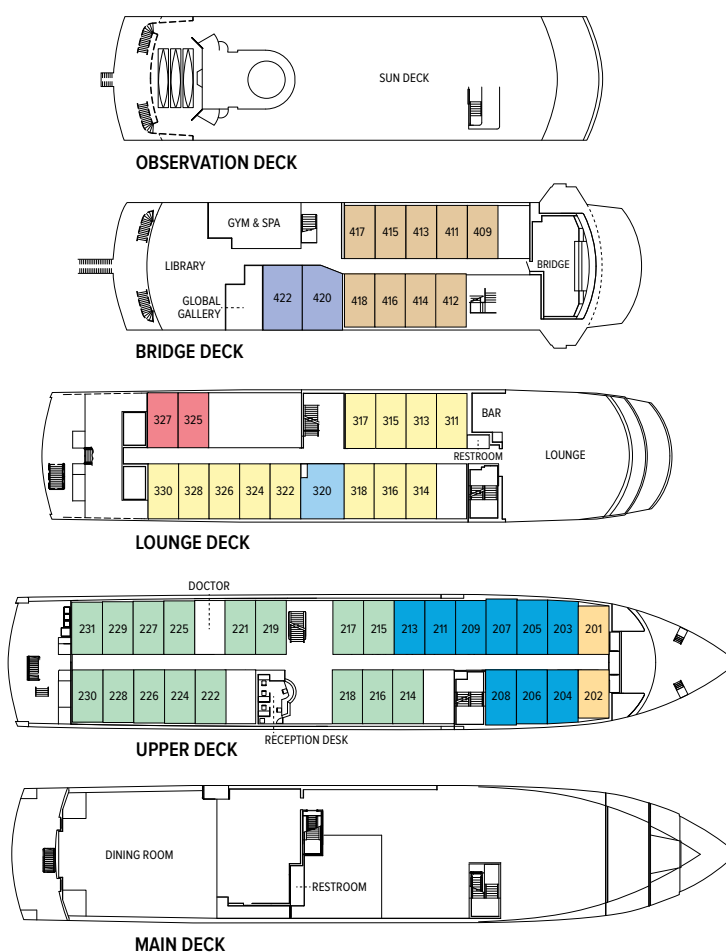

Prices are per person, double occupancy, in Australian dollars unless indicated as solo.

ITINERARY	CAT. 1	CAT. 2	CAT. 3	CAT. 4	SUITE A	SUITE B	CAT. 2 SOLO	CAT. 3 SOLO	DEPOSIT	NOTE	
2017 GALÁPAGOS: ABOARD NATIONAL GEOGRAPHIC ENDEAVOUR II PAGE 10											
Jan. 6 - Dec. 15	\$8,700	\$9,930	\$10,930	\$11,990	\$14,300	\$15,350	\$12,420	\$13,670	\$750	International and internal Ecuador tickets must be issued separately for all Galápagos voyages. Sample Internal Airfares: Guayaquil/ Galápagos: Adult from \$650 Children (Under 12) from \$325. Call for sample Peru airfare.	
Holiday: Dec. 22, 29	\$9,730	\$11,100	\$12,230	\$13,400	\$16,020	\$17,200	\$13,900	\$15,300	\$1,000		
2017 GALÁPAGOS + MACHU PICCHU & THE LAND OF THE INCA PAGE 16											
Jan. 6 - Nov. 17	\$15,810	\$17,040	\$18,040	\$19,100	\$21,410	\$22,460	\$21,250	\$22,500	\$1,500		
Dec. 15	\$16,730	\$17,950	\$18,950	\$20,010	\$22,330	\$23,380	\$22,160	\$23,410	\$1,500		
Holiday: Dec. 29	\$16,840	\$18,210	\$19,340	\$20,510	\$23,130	\$24,310	\$22,740	\$24,140	\$1,500		
2017 EPIC GALÁPAGOS PHOTO EXPEDITION ABOARD NATIONAL GEOGRAPHIC ENDEAVOUR II PAGE 16											
Dec. 1	\$17,400	\$19,850	\$21,850	\$23,980	\$28,600	\$30,700	\$24,890	\$27,330	\$1,500		



NATIONAL GEOGRAPHIC SEA BIRD & NATIONAL GEOGRAPHIC SEA LION IN ALASKA & BAJA

CAPACITY: 62 guests in 31 outside cabins.

REGISTRY: United States.

OVERALL LENGTH: 46 metres.

PUBLIC AREAS: Our twin sister ships feature a library; global market; lounge with full-service bar and facilities for films, slide shows and presentations; observation deck; partially covered sun deck with chairs and tables, and LEXspa. Our 'open bridge' provides guests an opportunity to meet our officers and captain and learn about navigation.

MEALS: Served in single seatings with unassigned tables for an informal atmosphere and easy mingling. Breakfast is a wide selection buffet and lunch is often served family style. Menu emphasises local fare.

CABINS: All face outside with windows, private facilities and climate controls.

EXPEDITION EQUIPMENT: Bow camera, hydrophone, kayaks, snorkelling gear, fleet of paddleboards, splash-cam, underwater video camera, video microscope, wet suits in Baja and expedition landing craft.

SPECIAL FEATURES: Guest internet access. A video chronicler is on board all voyages. A ship's doctor is on board in Baja and Costa Rica/Panama. An undersea specialist is on board in Baja and Alaska.

WELLNESS: The vessel is staffed by a wellness specialist and features exercise equipment, LEXspa and outdoor stretching area.



From top to bottom: Expedition ship National Geographic Sea Bird can access hard to reach locations; twin beds can be pushed together to form a double bed in Category 3 cabins on the Upper Deck; a comfortable Category 2 cabin freshly redesigned.



Our newly refurbished lounge.



Ceviche salad.

THE PRIVILEGE OF WILDNESS IN COMFORT AND STYLE

Our twin ships have been transformed: the lounge, bar and dining room have been handsomely renovated. And every cabin category has been refreshed with warm cherry veneer, our signature bed linens, sleekly framed photos and more. Now, each ship sets new standards for expedition hospitality and comfort.

CATEGORY 1: Main Deck #300-305—Conveniently positioned between the dining room & lounge, these cabins feature two single lower beds, and a large view window.

CATEGORY 2: Bridge Deck #100-104; Upper Deck #200-212, 215—These well-located cabins include two lower single beds & a view window.

CATEGORY 3: Bridge Deck #105, 106; Upper Deck #214, 216, 217, 219—These cabins feature a seating unit with table and two large view windows. Upper Deck cabins include two lower single beds which can convert to a double bed and a pull-out single bed for a third person; Bridge Deck cabins include two lower single beds only.

NOTE: Sole Occupancy cabins are available in Categories 1 and 2 only. Third person rates are available in certain categories at one half the double occupancy rate.

SHARED ACCOMMODATIONS: Shares can be arranged at the double occupancy rate in Categories 1 and 2 only.

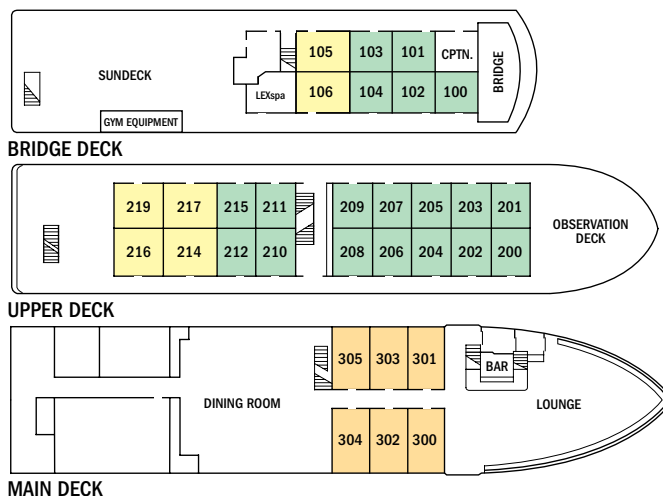

Prices are per person, double occupancy, in Australian dollars unless indicated as solo.

ITINERARY	YEAR	CAT. 1	CAT. 2	CAT. 3	CAT. 1 SOLO	CAT. 2 SOLO	DEPOSIT
Exploring Alaska's Coastal Wilderness – Page 12	2017	\$7,370	\$8,440	\$9,670	\$11,050	\$12,660	\$750
Wild Alaska Escape - Page 17	2017	\$5,370	\$6,240	\$7,490	\$8,050	\$9,370	\$750
Big Picture Alaska - Page 17	2017	\$11,240	\$13,120	\$14,870	\$16,870	\$19,680	\$1,000
Baja California and the Sea of Cortez: Among The Great Whales – Page 14	2017	\$8,240	\$9,490	\$10,740	\$12,370	\$14,240	\$750
Whales & Wildness: Spring in the Sea of Cortez – Page 17	2017	\$7,740	\$8,990	\$9,990	\$11,620	\$13,490	\$750
A Remarkable Journey to Alaska, British Columbia & Haida Gwaii – Page 17	2017	\$13,630	\$15,570	\$18,170	\$20,440	\$24,830	\$1,500
Wild Islands & Treasures of Baja California – Page 17	2016/17	\$7,490	\$8,740	\$9,990	\$11,240	\$13,120	\$750
Baja California: A Remarkable Journey – Page 17	2017	\$14,120	\$16,120	\$18,740	\$21,180	\$24,180	\$1,500

NEW SHIP



NATIONAL GEOGRAPHIC QUEST IN ALASKA

CAPACITY: 100 Guests in 50 cabins.

REGISTRY: United States. **OVERALL LENGTH:** 72 metres.

The *National Geographic Quest* will be the latest addition to the Lindblad-National Geographic fleet. Designed with over 50 years of expedition heritage, *National Geographic Quest* is able to explore the same remote locations we've sought out for decades while setting a new standard in comfort and style.

PUBLIC AREAS: Global gallery; fitness centre; LEXspa; lounge with full service bar and facilities for films and presentations; observation deck; mudroom with lockers for expedition gear, and a partially covered sundeck with chairs and tables. Our 'open bridge' provides guests an opportunity to meet our officers and captain and learn about navigation.

MEALS: Served in single seatings with unassigned tables for an informal atmosphere and easy mingling. Breakfast is a wide selection buffet and dinner is served family-style. Menu emphasises local fare.

CABINS: All cabins face outside with windows or portholes, private facilities and climate controls. Some cabins have balconies.

EXPEDITION EQUIPMENT: Expedition landing craft, a fleet of 24 kayaks, Remotely Operated Vehicle (ROV), hydrophone, splashcam, underwater video camera, video microscope, snorkelling gear for all guests (where applicable).

SPECIAL FEATURES: Guest internet access, elevator, Lindblad-National Geographic certified photo instructor, a video chronicler and undersea specialist.

WELLNESS: The vessel is staffed by a Wellness Specialist and features a gym with an elliptical machine, treadmill, exercycles, handweights and resistance bands. Treatments in the LEXspa are available by appointment.



Insets clockwise from top: (Artist's renderings): The lounge, with 270° views, is the hub of the expedition community; a spacious and open sun deck will provide unparalleled views.



Left to right: (Artist's renderings) Category 5 cabin is our most spacious. Category 4 cabin with lower single beds converted to a Queen and a private balcony. Select cabins connect via an inside doorway.

CATEGORY 1: Main Deck #301-306 Cabins feature two lower single beds that can convert to a Queen, a writing desk and two portholes.

CATEGORY 2: Main Deck #307-315 Cabins feature two lower single beds that can convert to a Queen, a writing desk and two portholes.

CATEGORY 3: Upper Deck #201-206 Cabins feature two lower single beds that can convert to a Queen, a writing desk and two full windows.

CATEGORY 4: Upper Deck #207-229 Cabins feature two lower single beds that can convert to a Queen, a writing desk, two full windows, and small, private balcony.

CATEGORY 5 (SUITE): Observation Deck #101-108 Cabins feature two lower single beds that can convert to a Queen, two full windows, an expanded bathroom, writing desk, ample storage space, and a convertible sofa bed to accommodate a third person.

NOTE: Sole Occupancy cabins are available in Categories 1 and 2 only. Third person rates are available in Category 5 cabins at one half the double occupancy rate.

Connecting Cabins via internal doorway access:
 Main Deck: #312-314, #311-315, #306-308, #305-307
 Upper Deck: #224-226, #225-227

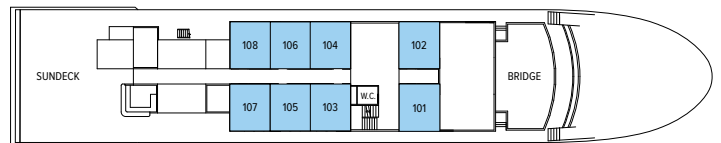

OBSERVATION DECK

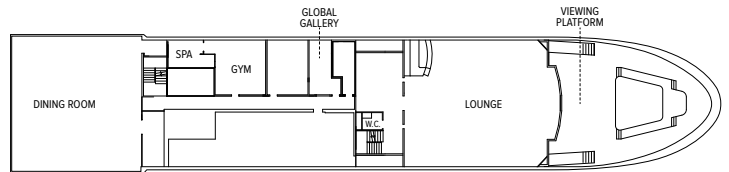

LOUNGE DECK



UPPER DECK

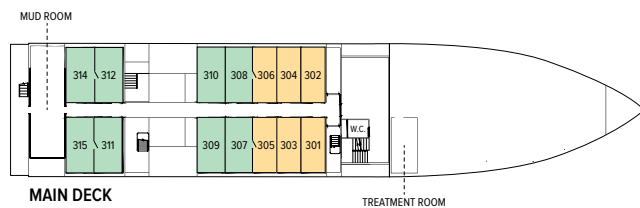

MAIN DECK

Prices are per person, double occupancy, in Australian dollars unless indicated as solo.

ITINERARY	CAT. 1	CAT. 2	CAT. 3	CAT. 4	CAT. 5 SUITE	CAT. 1 SOLO	CAT. 2 SOLO	DEPOSIT
Exploring Alaska's Coastal Wilderness – Page 12	\$8,240	\$9,120	\$9,740	\$10,870	\$11,990	\$12,490	\$13,250	\$750
Treasures of the Inside Passage: Alaska and British Columbia – Page 17	\$11,740	\$12,490	\$13,240	\$14,370	\$15,500	\$17,490	\$18,550	\$1,000

TAKE ADVANTAGE OF OUR SPECIAL OFFERS

BACK-TO-BACK SAVINGS: Save 10% on any consecutive journeys taken aboard *National Geographic Explorer* and *National Geographic Orion*. This saving is applicable on voyage fares only, and is not valid on extensions or airfare.

TRAVELLING AS A GROUP: Save 5% when travelling as a group of 8 or more people. Take advantage of these great savings, while enjoying travelling with your friends and family. This saving is applicable to voyage fares only, and is not valid on extensions or airfare. Deposit, final payments, and cancellation policies for group travel vary from our regular policies.

BRINGING THE KIDS: We believe sharing an expedition with your kids or grandkids is a life-enhancing experience. So, take \$500 off for each child under the age of 18.

COMBINING OFFERS: Certain offers may be combinable, up to two savings opportunities except where noted otherwise. For example, travel with a group of 8 or more on back-to-back expeditions, and take advantage of both savings!



INCLUSIVE PRICING

We include just about everything you have the opportunity to do as part of your expedition aboard ship and ashore. The only things not included are those of a personal nature—alcohol, internet usage, tips to the crew, wellness treatments and other specialised arrangements.

ABOARD SHIP

- ✓ All meals and non-alcoholic beverages
- ✓ Cappuccinos, lattes & complimentary refillable water bottle
- ✓ 24-hour coffee, tea & soft drink on demand
- ✓ Hors d'oeuvres & snacks during lounge recap
- ✓ Sauna
- ✓ Fitness centre
- ✓ Fully stocked library
- ✓ The guidance and company of our expedition staff

ASHORE

- ✓ Meals on land, as indicated in itinerary
- ✓ Special access permits, park fees, port taxes
- ✓ Transfers to and from group flights
- ✓ The expertise of our expedition staff

ACTIVITIES

- ✓ All excursions
- ✓ Paddleboarding
- ✓ Zodiac & kayak explorations
- ✓ Lectures & presentations in the lounge



LOG ON TO EXPEDITIONS.COM

Find everything you need to dream, research or plan travel to 40+ destinations worldwide.

**Be part of our expedition community
Join in! Here's how:**

- ▶ Check our daily blog: expeditions.com/blog
- ▶ Like us on Facebook: get inspired and chime in: facebook.com/LindbladExpeditions
- ▶ Subscribe to our videos on youtube.com/lindbladexpeditions
- ▶ Follow @LindbladEXP on Instagram and Twitter, and find Sven Lindblad on Instagram at @solindblad
- ▶ Check out Expedition Snapshots from guests and upload your own on the expeditions.com homepage



RESERVATION INFO

Costs Include: All accommodations aboard ships or in hotels per itinerary or similar, all meals and non-alcoholic beverages aboard ship, meals on land as indicated, air transportation where indicated as included, shore excursions, sightseeing and entrance fees, special access permits, transfers to and from charter flights, use of snorkelling equipment and wet suits, use of kayaks (where available), tips (except to ship's crew), taxes and service charges, services of a ship physician on most voyages, and services of our expedition staff. **Note:** All departures aboard *Sea Cloud*, select 2016 departures aboard *NG Orion* (where indicated), and all departures after March 2017 aboard *NG Explorer* and *NG Orion* include alcoholic beverages and tips to the ship's crew (where indicated). Where free airfare is included in place of a special savings offer, luggage is not included in the cost.

Not Included: Air transportation (except where shown as included), extensions, passport, visa, immigration fees, scuba diving (where available), meals not indicated, travel insurance, items of a personal nature, such as alcoholic beverages, internet, voyage DVD (where available), laundry. Gratuities to ship's crew are at your discretion. **Note:** All departures aboard *Sea Cloud* and some departures aboard *NG Orion* (where indicated) include the cost of alcoholic beverages and tips to the ship's crew.

Airfare: For all programs, airfare is an additional cost unless otherwise indicated. Sample airfares are subject to change. We will gladly assist in making your air arrangements for a \$50 per person service fee.

TERMS & CONDITIONS

Reservations: To reserve your place, a deposit is required at the time of reservation. The per person deposit amount varies by program, and is outlined in our brochures, as well as on our website. Holiday departure dates and certain longer voyages may carry additional advance deposit requirements due to high demand for these voyages. Payment is accepted by Visa, MasterCard, American Express, Direct Debit or Australian Dollar cheque.

Receipt of your initial payment indicates your acceptance of our complete Terms and Conditions. We require written notice at the time of reservation for any physical condition, diet, or treatment requiring special attention.

Once your reservation is confirmed, we urge you to use your personalised online account for important information to help you prepare for your voyage. Managing your documents online will facilitate fast and accurate communication, and allow you to provide us with pertinent details we require, in order to complete your reservation. Your online account gives you access to your Expedition Guide, which includes valuable information specific to your voyage. You can also use your online account to make easy payments, view recommended flights and reading material, packing list, and so much more.

Final Payment: Expeditions on board all ships with exception of *Explorer* and *Orion*, final payment is due 90 days prior. Expeditions on board *Explorer* and *Orion*, payment is due 120 days prior to departure.

Payment schedules may vary for Holiday departures and certain longer voyages, due to high demand for these voyages. We reserve the right to cancel your reservation if payment has not been received by final payment due date.

Travel Insurance: We strongly recommend that you take advantage of our Travel Insurance. This plan offers comprehensive coverage to protect you from cancellation fees, costs incurred due to trip delays/interruption, damaged or lost baggage, medical assistance and evacuation during your travels. Travel insurance premiums are non-refundable once plan is purchased.

Smoking Policy: Smoking is allowed only in designated outdoor areas.

Responsibility and Other Terms & Conditions: Certain other provisions concerning, among other things, limitations of Lindblad Expeditions' and the National Geographic Society's liability for loss of property, injury, illness or death during the voyage will also apply to your expedition. When confirming your reservation and paying your deposit, you will be asked to read and accept the Cruise Ticket Contract Terms. You may also ask for a copy or review the Cruise Ticket Contract Terms at www.expeditions.com/terms. By registering for a trip, the guest agrees to all such terms and conditions.

Note: Itineraries and prices listed in this brochure are valid as of publication date, and are subject to change. Under normal conditions, the total expedition cost is guaranteed at the time of booking. However, the published price is determined far in advance of initial departure on the basis of then-existing projections of fuel and other costs. In the event we determine that current costs create an unsustainable financial model, including but not limited to increases in the price of fuel, currency fluctuations, increases in government taxes or levies, or increased security costs, we reserve the right to pass on these costs to you, to cover such unexpected increases. We will always provide a transparent accounting of the reason for such an increase in costs.

Australian Government Department of Foreign Affairs and Trade travel warning for Mexico is currently in effect (<http://smartraveller.gov.au>). The area of concern noted in the warning is not near the region we visit on this itinerary. We expect to operate these expeditions as planned, but will continue to closely monitor events in the country.

CANCELLATION POLICY	
Number of Days Prior to Expedition Start	Per Person Cancellation Fee
120 or more days	\$350*
119–90 days	Loss of deposit
89–60 days	25% of total fare
59–45 days	50% of total fare
44–0 days	No refund

AU\$350 will be rewarded in the form of a Lindblad Expeditions Travel Certificate. This cancellation policy applies to expeditions as well as extensions and other additional services. The effective date of a cancellation will be the date on which your notice is received. **Note:** Airline cancellation policies vary by carrier, as well as the type of fare used to issue your ticket. Any revisions you make within the cancellation penalty period, such as departure date or choice of voyage, are subject to cancellation fees. Additional Terms and Conditions may apply. For complete terms, please visit our website at www.expeditions.com/terms.

We are proud to be a Founding Member of Adventure Collection—a family of the world's most trusted and experienced active travel companies. Each member company of Adventure Collection is dedicated to enriching the lives of its guests and to giving back to the areas in which it travels. For more information visit www.AdventureCollection.com.



Photo Credits: Alamy, Ken Carlson, Stewart Cohen, Alexandra C. Daley-Clark, Jennifer Davidson, Mike Greenfelder, Cindy Hopkins / Alamy, Ralph Lee Hopkins, Branko Ivelic, Sven-Olof Lindblad, Jeff Litton, Michael S. Nolan, Marco Ricca, Andy Rouse/Bluegreen Pictures/Alamy, Max Seigal, Rikki Swenson, Mark Thiessen, David Vargas

Lindblad Expeditions:
Level 2, 8 West Street, North Sydney, NSW, 2060

Reservation hours:
Monday – Friday 9:00am – 5:30pm AEST

Australia: 1300 361 012

NZ: 0800 444 462 Int'l: +61 (02) 9033 8700

Email: auinfo@expeditions.com

For additional information please contact your travel agent or visit www.expeditions.com

©2016 Lindblad Expeditions

Lindblad Expeditions and the Eye are the trademarks of Lindblad Expeditions. All rights reserved.

NATIONAL GEOGRAPHIC and the Yellow Border are the trademarks of the National Geographic Society.

All rights reserved.

TOP 10 REASONS WHY FAMILIES CHOOSE TO TRAVEL WITH LINDBLAD-NATIONAL GEOGRAPHIC

- 1** We have 50 years of expedition travel experience. Since 1966, we've been leading citizen-explorers to the world's wildest and most fascinating geographies.
- 2** We plan it all from round-trip flights to daily activities to special gear and kid-friendly meal options, we create a seamless experience for your family.
- 3** We keep it flexible. Activities are 100% optional, and everyone can gravitate toward their interests—photography, kayaking, hiking, and more.
- 4** We create multi-generational fun with activities tiered for every fitness level and age group.
- 5** We offer a family travel discount—kids under 18 get \$500 off! We invite you to take \$500 off the cost of your expedition for each child under the age of 18 travelling.
- 6** Naturalist-led hands-on science and conservation projects get young explorers learning while having fun.
- 7** Our ships have cool tools for exploration, including snorkelling gear, underwater video cameras, hydrophones, bow-cams, kayaks, expedition landing craft, and more.
- 8** Lindblad-National Geographic certified photo instructors on every departure help families capture the images of a lifetime.
- 9** Small ship environment is ideal for families, providing the perfect balance of intimacy and independence.
- 10** We offer engaging activities just for kids, including scavenger hunts, movie nights, star-gazing, and nautical knot-tying lessons.

AUSTRALIA: 1300 361 012 NEW ZEALAND: 0800 444 462
WWW.EXPEDITIONS.COM OR SEE YOUR TRAVEL AGENT

FAM-A56

